

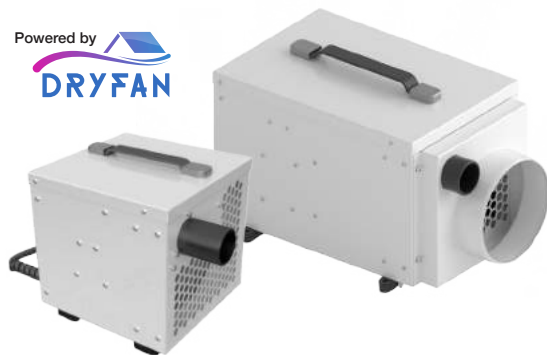

# DRYFAN<sup>®</sup> DEHUMIDIFIER

## DF8 & DF12

Powered by  
The DRYFAN logo consists of a stylized blue and purple wave graphic above the word "DRYFAN" in a bold, blue, sans-serif font.



USER MANUAL

## DEAR CUSTOMER

Thank you for purchasing the DryFan® Dehumidifier. The DryFan® Dehumidifier helps to monitor the humidity and remove excess moisture from the air, keeping your living spaces, lofts, basements, boats, holiday homes, garages and storage areas dry all day and every day.

This dehumidifier can even be used for industrial processes and applications. It is designed to be used almost anywhere, in any orientation and will even work upside down. It will perform similar to compressor dehumidifiers rated at double the capacity at normal room conditions.

Using DryFan® technology, this dehumidifier will out-perform compressor dehumidifiers by 3–4 times below 10 °C. Where compressor dehumidifiers stop working at 5 °C, this unit will continue to dry spaces and continue to work to -20 °C making them ideal for unheated rooms and out-buildings.

Please read this manual carefully before use to ensure proper usage and save these instructions for future reference.

The package includes:

- DryFan® Dehumidifier
- User Manual

40% RH - 60% RH



We feel comfortable  
within these settings.

## INDEX

IMPORTANT SAFETY INSTRUCTIONS.....	3
HOW IT WORKS.....	4
UNIT SETUP.....	8
OPERATING INSTRUCTIONS.....	10
SPECIFICATIONS.....	12
WARRANTY DETAILS.....	13
WARRANTY REGISTRATION.....	15

## IMPORTANT SAFETY INSTRUCTIONS

### PLEASE READ ALL INSTRUCTIONS CAREFULLY BEFORE OPERATING.

When using electrical appliances, basic safety precautions should always be followed:

- The unit is designated for indoor operation.
- This appliance is not intended for use by persons (including children) with reduced physical, sensory or mental capabilities, or lack of experience and knowledge, unless they have been given supervision or instruction concerning the use of the appliance by a person responsible for their safety.
- Children should be supervised to ensure that they do not play with the appliance.
- Do not clean the dehumidifier by spraying it or immersing it in water.
- Do not insert any object into the opening of the dehumidifier.
- Disconnect from the mains before cleaning the unit or any of its components.
- Never connect to an electrical outlet using an extension cord. If an outlet is not available, one should be installed by a licensed electrician.
- Place the dehumidifier in location appropriate to the appliance IP rating (see technical data).
- Any service other than regular cleaning setting fan mode or filter replacement should be performed by an authorized service representative. Failure to do so could result in a loss of warranty. Your dehumidifier is supplied with an electrical cable (4200 mm) and an earthed plug. Should it be necessary to replace this plug at any time, you must use an earthed electrical plug.
- Never operate this appliance if it has a damaged cord or plug. If the supply cord is damaged an approved service representative or a similar qualified person must replace it in order to avoid any hazards.
- There should be direct access to the electrical plug after connecting the power.
- Do not use your dehumidifier under the following conditions:
  - if the power cable is damaged
  - close to heat source
  - where small children may be left unattended
  - where the power cable may be easily damaged
  - where there is a risk of liquids falling on the unit
  - where it may be damaged by chemicals
- This product is not made for DIY repair.



**The installation must be in accordance with the regulations of the country where the unit is used.**



**This appliance must be earthed and should only be connected to an earthed 220 – 240 V / 50 Hz mains supply.**

## HOW IT WORKS

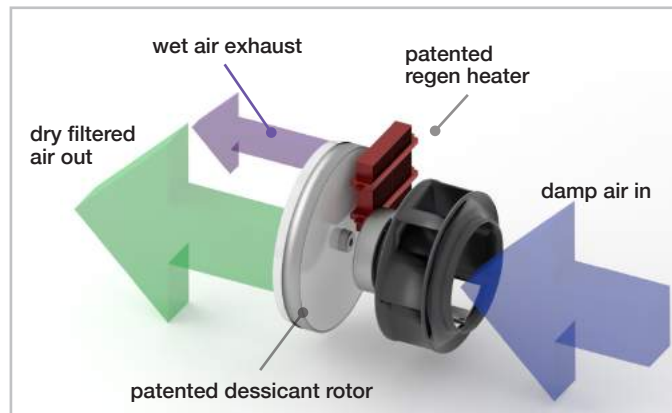

Your dehumidifier uses DryFan® technology and uses a continuously rotating moisture absorbing patented wheel termed a “rotor”.

A highly efficient yet low noise fan draws air into the unit (Process Air) and forces it through a section of the rotor. As the air passes through the rotor, the honeycomb, of hygroscopic membranes absorbs almost all of the moisture creating an extremely dry airstream.

Most of this airstream (approx 85%) is discharged directly through the ‘Dry Air Outlet’.

However, a portion, (approx 15%) of this air (Regen Air) is separated and directed through a special heater bank (Regen

Heater) where the air’s temperature is raised. This heated air is then channelled back through a section of the rotor.

As this hot air passes through the membranes, its higher temperature drives-out the previously absorbed moisture and discharges it as warm wet air through the ‘Wet Air Out’ duct. As the wheel rotates, this process of collecting and discharging moisture is continuous.

The wet air outlet is 41 mm in diameter making it easy to vent the moisture away using standard push fit waste water connectors.

Water is not drained away as a liquid it is vented away similar to a tumble dryer.

## HOW IT WORKS

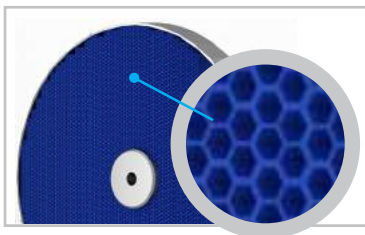

### PATENTED DESICCANT ROTOR

The Desiccant Rotor is the heart of the DryFan® system. It is an array of especially absorbent membranes – patent protected – arranged as a series of corrugations (as shown in the cut-away image) to give a vast surface area that was developed over many years, making it an extremely efficient moisture collector.

### PATENTED REGEN HEATER

A patented ceramic PTC Regen Heater. (PTC Positive Temperature Coefficient) is self regulating it never overheats. However, as triple safety we include a separate overheat smart sensor in the dehumidifier. The patented technology is both safe and energy efficient and can never overheat to hazardous temperatures, even if vents become accidentally blocked.

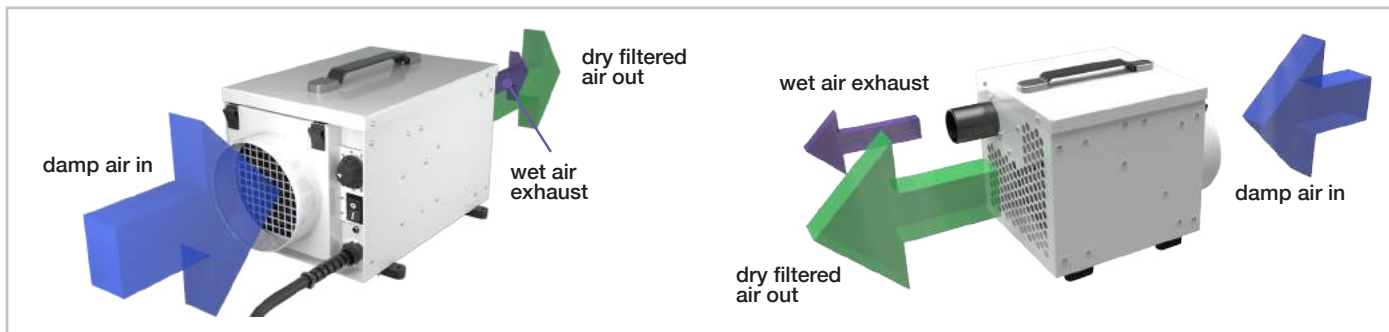
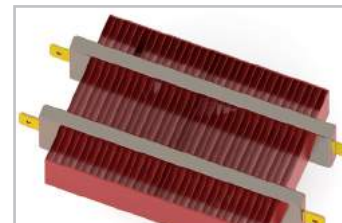

# HOW IT WORKS

## FAN SYSTEM

All models use specialised fan technology to give quiet performance but type of fan will differ by model capacity.

Note: External ductwork will reduce restrict airflow and therefore the amount of water the dehumidifiers will extract. To maximise airflow and water extraction always keep any ducting to minimum. Maximum lengths of any ducts are outlined in the table.

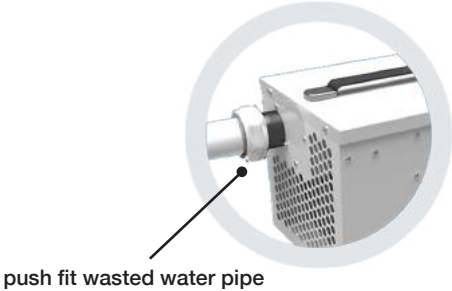

### DF8 DryFan® Dehumidifier

Maximum wet air out duct length (m)	0.6
Maximum process air in duct length (m)	1.0
Maximum process air out duct length (m)	No duct flange / not applicable

A diagram showing the DF8 DryFan Dehumidifier unit with a supply cord and two ducts. The supply cord is labeled "supply cord 4200 mm". The ducts are labeled with their maximum lengths: "max. 1000 mm" for the process air in duct and "max. 600 mm" for the process air out duct.

### DF12 DryFan® Dehumidifier

Maximum wet air out duct length (m)	1.0
Maximum process air in duct length (m)	3.0
Maximum process air out duct length (m)	3.0

A diagram showing the DF12 DryFan Dehumidifier unit with a supply cord and two ducts. The supply cord is labeled "supply cord 4200 mm". The ducts are labeled with their maximum lengths: "max. 3000 mm" for the process air in duct, "max. 1000 mm" for the process air out duct, and "max. 3000 mm" for the wet air out duct.

## HOW IT WORKS

### CONTINUOUS FAN OR FAN ON WHEN DRYING ONLY MODES

The DryFan® Dehumidifier can be used in two modes:

**Mode O** – The fan is always blowing and circulating air continuously dehumidifying at the set humidity point by the humidistat. This has the benefit of a faster reaction time to fluctuating humidity levels.

**Mode I** – The fan is working only when needing to dry the air. The reaction time to humidity level change may be up to 1 hour in this mode, but it is more energy efficient and of course quieter working only when needed.

### SELECTING FAN MODE

Modes for the fan can be changed by disconnecting the dehumidifier from the power supply by unplugging. Remove the four screws holding the top cover in place with a screwdriver. On the inside just under the lid is a switch. Pressing the switch will mean mode change from one mode to the other.

Replace the cover the right way round (there is only one way for all screws to align). Put screws back into position taking care not to overtighten.

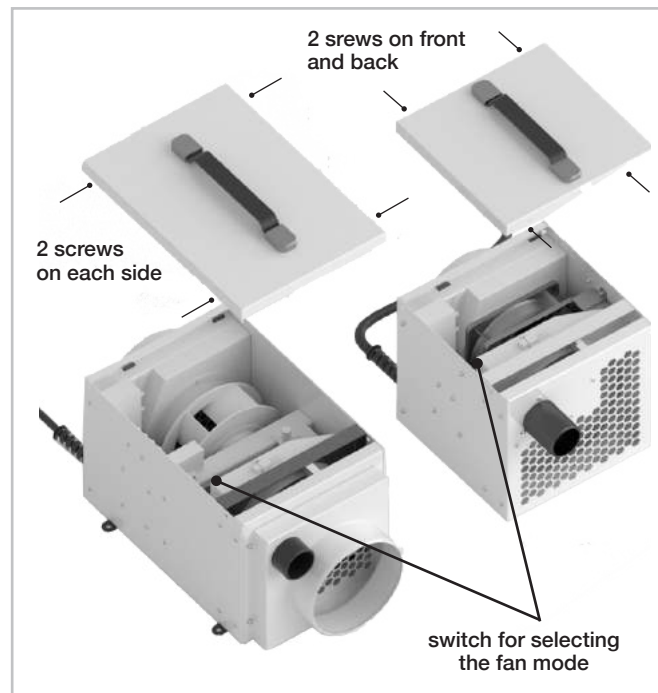

## POSITIONING THE DF8 DRYFAN® DEHUMIDIFIER

The DF8 DryFan® Dehumidifier have been designed for indoor use however, it can be placed inside or outside the room to be dried.

### Internal Positioning:

When positioning the unit inside the room, place it centrally, ensuring inlet and outlet ducts are clear of obstruction. If required, ducts can be connected to the outlet and/or inlet (where fitted) to direct the drying to specific areas. The 'Wet Air Out' MUST be ducted outside the room.

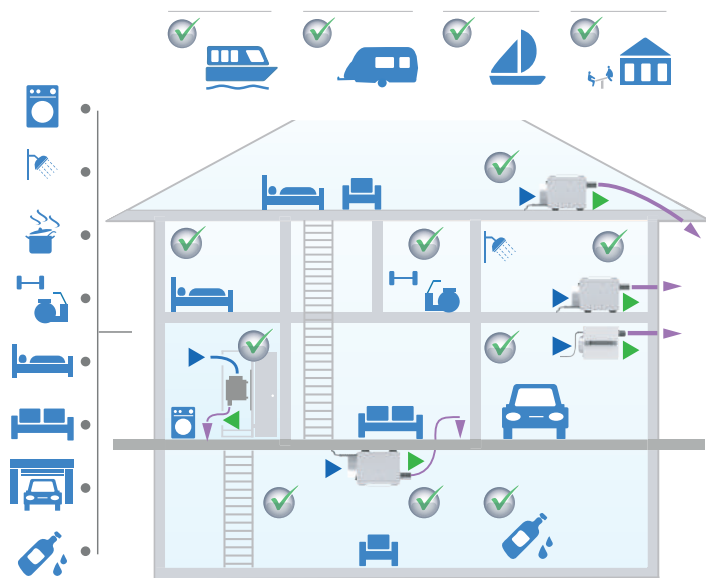

in the basement



in the gym

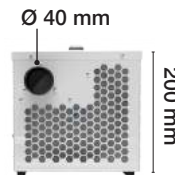
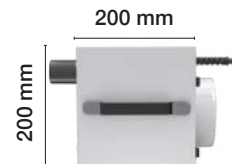
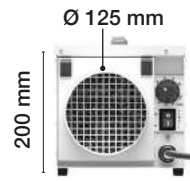



## POSITIONING THE DF12 DRYFAN® DEHUMIDIFIER

### External Positioning (Models where Outlet Duct Fitted Only):

When positioning the unit outside the room, connect ducting to the outlet to direct the dry airstream into the room to be dried. Optionally, the inlet may also be ducted to the room to give a re-circulation effect. In this case however, because the unit uses a portion for the inlet air for regeneration. Provision must be made in the inlet duct to draw air also from outside the room.

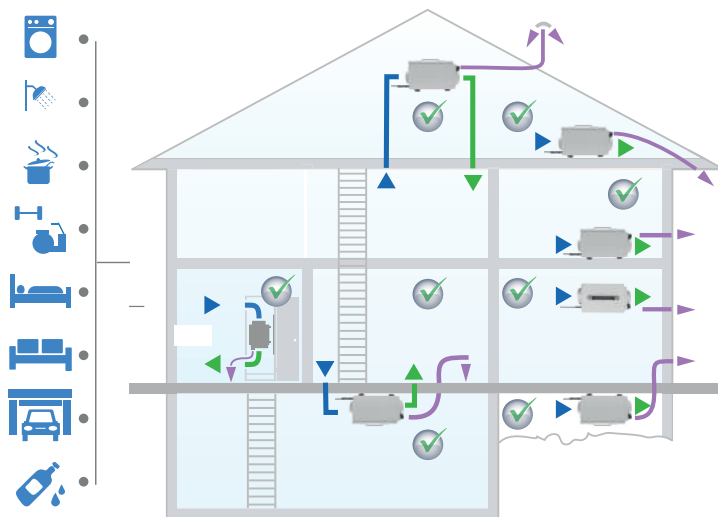

for more than  
one room

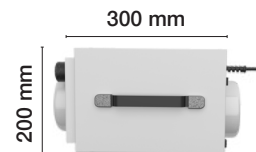
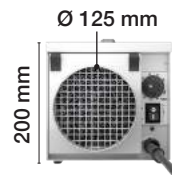

## UNIT SETUP

### NOTE:

1. As the wet-air-out discharge is warm and very humid, ensure it is directed where it will have no adverse effect on the immediate environment.
2. Wet-air-out should be declined from the dehumidifier where possible if there is a risk of any condensation build up in the exhaust duct running back into the dehumidifier.  
This can be avoided either with short wet-air-out duct lengths or adequately insulating the wet-air-duct to prevent condensation. Should water be seen dripping from the dehumidifier switch off the appliance immediately at the wall socket. Allow water in the unit to dry completely.  
Correct the defect in the wet-air-out ducting and reconnect to the power to start operating again.  
Do not operate If there is a concern the unit is not thoroughly dry inside.
3. The wet-air-out flange outlet is 40 mm. This is the standard size of push fit wasted water pipe connectors and pipes ideal for exhaust ducting.  
Decreasing the exhaust pipe diameter will decrease performance. Flexible ducting may be used on all inlets and outlets. All ducting lengths should be kept to a minimum. Longer lengths will reduce performance.  
For the longest lengths see FAN SYSTEM section (page 6). Ducting may be also supplied by your dehumidifier supplier.



to the ceiling



in a closet



in a laundry room

## OPERATING INSTRUCTIONS

### CONTROLS

The controls are positioned on the front of the unit next to the air outlet duct, they are:

1. Humidistat
2. Remote Humidistat Switch
3. Remote Humidistat Jack Plug Socket

Auto reset. If there is a power out the dehumidifier will automatically restart when the mains power is reconnected.

### MOUNTING

The dehumidifier can be mounted in any direction even up-side-down.

Turn the feet out to see the anchoring points. Secure all four feet with suitable fixings (not provided) to floor, wall or ceiling.

### STAND-ALONE OPERATION

Connect the unit to suitable mains supply and connect ducting, Ensure the 'Remote Humidistat' switch is set to the 'OFF' position (O). Turn humidistat to lowest humidity level continuation or set the switch to the 'ON' position (I). The fan will start. Set the humidity level right for the room to be dried.

Follow the steps in SETTING FAN MODE to alter the fan mode as needed (see page 7).

**NOTE:** A low setting of say 10% means the room is regulated to a very dry level while a setting of say 90% the room will be maintained at a relatively humid level. The right level for the room may vary with weather, temperature and occupation conditions over time.

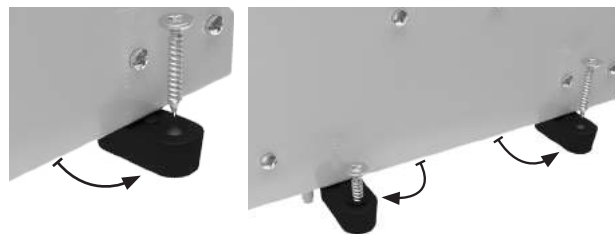
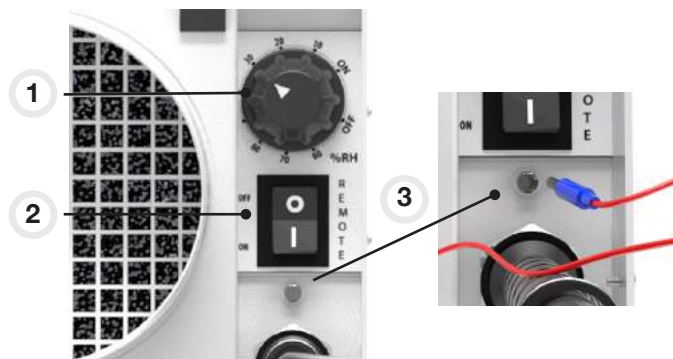

## OPERATING INSTRUCTIONS

### REMOTE OPERATION

For remote operation it is necessary to connect an 24V external humidistat (not provided) via the jack plug connector. The external humidistat may be obtained from your appliance supplier.

Ensure the “Remote Humidistat” switch is set to ‘ON’ (O). The dehumidifier will now be controlled by the remote humidistat that is using low power and only 24V.

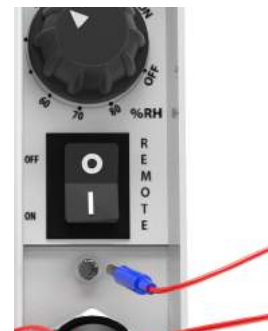

### CLEANING

Disconnect from the mains before cleaning or servicing the unit or any of its components. Wipe thoroughly clean with a moist cloth (a soft, damp cloth) and a mild household detergent, never use chemicals, petrol, aggressive detergents or other cleansing solutions.

### AIR FILTER

The dehumidifier has an inlet air filter. This should be checked periodically and if necessary cleaned.

It can be cleaned with a vacuum cleaner or hand washed in mild detergent only.

Replacement filters are available from your supplier.

**ATTENTION:** Do not run the unit without a filter fitted as dust will impair the performance of the Rotor.

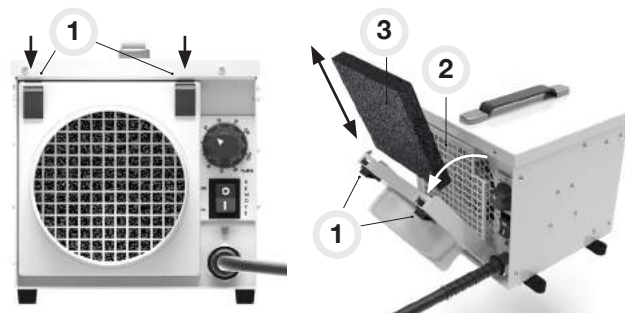

## SPECIFICATIONS

Model	DF8 DryFan® Dehumidifier	DF12 DryFan® Dehumidifier
Typical extraction @ 35°C 90% rh	8 l/day	12 l/day
Typical extraction @ 27°C 60% rh	6 l/day	10 l/day
Air flow (Process)	130 m³/h	130 m³/h
Air flow (Regen)	20 m³/h	20 m³/h
Mains	230V ~ 1 phase • 50 Hz	230V ~ 1 phase • 50 Hz
Current @ 27°C 60% rh	2.2 A	2.2 A
Power @ 27°C 60% rh	0.50 kW	0.50 kW
Plug	13 A	13 A
Operating temperature range	-20°C — + 40°C	-20°C — + 40°C
Noise level	44 dB	44 dB
Optional Parts	Wet air exhaust flexible ducting: 1 meter length Process air In or process air out flexible ducting - 3 meter length Remote humidistat - 5 meter cord length and jack plug Replaceable filters - pack of 3 Blank replacement top plate without handle - pack of one	
IP rating	IP22	IP22
Dimensions l x d x h mm	200 x 200 x 200	200 x 300 x 200
Weight net/gross	4.5 kg/4.8 kg	5.7 kg/6.6 kg

Subject to modifications.



This marking indicates that this product should not be disposed with other household wastes throughout the EU.  
 To prevent possible harm to the environment or human health from uncontrolled waste disposal, recycle it responsibly to promote the sustainable reuse of material resources.  
 To return your used device, please use the return and collection systems or contact the retailer where the product was purchased.  
 They can take this product for environmental safe recycling.



## WARRANTY DETAILS

Congratulations on your purchase! It is our aim to provide you with quality products that you can trust. Our products come with guarantees that cannot be excluded under the Australian Consumer Law. You are entitled to a replacement or a refund for a major failure and for compensation for any other reasonably foreseeable loss or damage.

You are also entitled to have the goods repaired or replaced if the goods fail to be of acceptable quality and the failure does not amount to a major failure.

### The Guarantee

The product is guaranteed to be free from defects in workmanship and parts for a period of 12 months from date of purchase for domestic use and 3 months for commercial use. Defects that occur within this warranty period, under normal use and care, will be repaired, replaced or refunded at our discretion, solely at our option with no charge for parts and labour. The benefits conferred by this warranty are in addition to all rights and remedies in respect of the product that the consumer has under the Trade Practices Act and similar state laws.

### Proof of Purchase

This warranty is valid for the original purchase and is not transferable. Please keep your purchase docket or receipt as proof of purchase and as proof of date on which the purchase was made. The purchase docket (or a copy) or receipt must be presented with the warranty when making a claim under this warranty.

### Service during the Warranty Period

To claim for warranty, contact us on 1300 800 200 or support@andatech.com.au to get an RA# (Return Authorization Number) or submit a support ticket on my.andatech.com.au. Ensure that the RA# is clearly stated on the outside of the

packaging and that the product is properly packaged so that no damage occurs to the product during transit. Shipping of the product back to us for warranty will be at your cost. A product return without the RA# or proof of purchase will not be accepted.

### Extent of Warranty

This warranty is limited to defects in workmanship or parts. All defective products or parts will be repaired or replaced. This warranty does not cover manuals and packaging.

### Normal Wear and Tear

This warranty does not cover normal wear and tear to the product or parts.

### Exclusions

This warranty does not cover:

- Any defect caused by an accident, misuse, abuse, improper operation, lack of reasonable care, unauthorised modification, loss of parts, tampering or attempted repair by a person not authorised by the distributor.
- Any product that has been damaged by a lightning strike either directly or indirectly or a mains power surge or liquid ingress.
- The product if it is located outside of Australia.
- Any damage caused by improper power input or improper cable connection.

# WARRANTY REGISTRATION

Register your Ionmax+ DryFan® Dehumidifier online at [my.andatech.com.au](http://my.andatech.com.au)

Alternatively, fill out this form and forward to the address below with a copy of your proof of purchase.

Andatech Pty Ltd  
PO Box 3038, Nunawading VIC 3131, Australia.

Product: ☐ Ionmax+ DF12      ☐ Ionmax+ DF8

Date of Purchase : \_\_\_\_\_ Place of Purchase : \_\_\_\_\_

Serial No. : \_\_\_\_\_

Surname : \_\_\_\_\_ Given Name : \_\_\_\_\_

Address : \_\_\_\_\_

Suburb : \_\_\_\_\_

Postcode : \_\_\_\_\_ State : \_\_\_\_\_

Contact No. : \_\_\_\_\_

Email : \_\_\_\_\_





[andatechglobal.com](http://andatechglobal.com)  
1300 800 200

Version 2.0. Updated 4 April 2018.