

DROWSIE INSTRUCTIONS



1. ON/OFF

Press and hold the 'Drowsie logo' button for 3 seconds to turn on/off.

Once a flashing blue/red light appears, Drowsie is ready to be paired.

Additional buttons:

Right - Press and hold to turn the volume down. Click once to skip to the next track.

Left - Press and hold to turn the volume up. Click once to skip to the previous track.



2. Bluetooth

On your phone, navigate to Settings > Bluetooth & Select 'SweetDreams' from the list of new devices.



3. Playing Sounds

To play sounds, navigate to the app that you wish to use, place Drowsie under your pillow and press play.

You can control the volume through your phone.

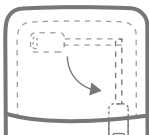

4. Charging

Using your fingers, retract the fabric lip & pull to expose the charging cable.

Connect the USB cable provided to the charging cable on one end, and to a power point adapter on the other.

Red light: Drowsie is charging.

Blue light: Drowsie is fully charged.



5. Battery Life

A 2-hour charge provides 10+ hours of play time.

Charge every day if you play sounds all night.

Charge every 3-4 days if you play sounds for 2-3 hours a night.



6. Maintenance

Drowsie contains electronics that may cease to work if exposed to water.

Do not wash Drowsie in washing machine or submerge in water.

Use wet wipes to gently wipe off any marks and air dry.



7. Tips

To save battery:

Double click the *Left* button to set Drowsie to turn off automatically after 1 hour.

Double click it again to set it to turn off after 2 hours.

Double click it again to set it to play all night.

For the best Drowsie experience, place it under your pillow directly below your ear.

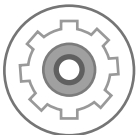

8. Troubleshooting

VOLUME: If you find that Drowsie is not loud enough under your pillow, the solution in most cases is to adjust your device settings.

iPhone users:
Go to 'Settings > Music > EQ > Select Late Night'.

For further help with volume troubleshooting or any other issues, please email us at info@drowsie.com.

STANDARD ONE YEAR MANUFACTURER WARRANTY

The manufacturer warrants this product to be free from defects in workmanship and materials, under normal residential use and conditions, for a period of one (1) year for the original invoice date. Shipping and handling fees are to be paid for by the customer. The manufacturer agrees, at its option during the warranty period, to repair and defect in material or workmanship or to furnish a repaired or refurbished product of equal value in exchange without charge (except for a fee for shipping, handling, packing, return postage, and insurance which will be incurred by the customer). Such repair or replacement is subject to verification of the defect or malfunction and proof of purchase as confirmed by showing the model number on original dated sales receipt.

ELECTRONICS PRODUCT AND BLUETOOTH WARRANTIES:
The manufacturer warrants electronic parts including head unit, speakers and wiring against manufacturing and failure defects. The manufacturer warrants bluetooth connection against being unable to connect and/or loss of connection for one year.

FABRIC
The manufacturer warrants fabric against; seam failure and fabric separation for one year. The manufacturer cannot cover dirty fabric, which is a result of normal wear, nor fading.

WARRANTY LIMITATIONS
This warranty does not include:
- Any condition resulting from other than ordinary residential wear or any use for which the product was not intended, such as use in circumstances other than for sleeping.

- Any condition resulting from incorrect or inadequate maintenance or care.
- Damage resulting from misuse, abuse, negligence, accidents or shipping damage.
- Dissatisfaction due to buyer's remorse, except within 30 days of purchase as per our '30 Day Money Back Guarantee'.
- Normal wear and tear.
- Damages incurred during transportation.
- Damages incurred during assembly or maintenance.

The Company makes no express warranty or condition whether written or oral and the company expressly disclaims all warranties and conditions not stated in this limited warranty.

To the extent allowed by the local law of jurisdictions outside Australia and the United States, the Company disclaims all implied warranties or conditions, including any implied warranties of merchantability and fitness for a particular purpose.

For all transactions occurring in Australia and the United States, any implied warranty of condition of merchantability, satisfactory quality, or fitness for a particular purpose is limited to the duration of the express warranty set forth above.

Some states or countries do not allow a limitation on how long an implied warranty lasts or the exclusion of limitation of incidental or consequential damages for consumer products. In such states or countries, some exclusions or limitations of this limited warranty may not apply to the Purchaser.

For consumer transaction, the limited warranty terms contained in this statement, except to the extent lawfully permitted, do not exclude, restrict, or modify but are in addition to the mandatory statutory rights applicable to the sale of this Product to the Purchaser.

All warranty claims must be filed by the consumer to the manufacturer of this product.

CLAIM PROCEDURES:
- Claims for defective merchandise must be made within ONE year from invoice date. Claims for missing parts must be made within 60 calendar days after the merchandise is received
- Any claim for defective merchandise returns must be packed in original packaging
- We reserve the right to specify that items be returned to the original warehouse for inspection
- Pictures are required to claim defective merchandise, along with a copy of the original invoice
- If the claim is justified, the item(s) or part(s) will be repaired or replaced or a credit will be issued. It is our policy to replace parts whenever possible
- This warranty gives you specific legal rights. You may have other rights, which vary from country to country, and state to state.

TECHNICAL SPECIFICATIONS

Bluetooth®: 5.0

Power Source: 3.7v, 160mAh, Li-Ion

Usage Hours: Max 14 hours

Standby Time: Max 50 hours

Charging Time: Approx. 2 hours

Speakers: Impedance: 32 Ohm
Power: 10 mW

Charging Cable: Micro B USB

Weight: 95g

Materials: Cotton, Foam
Electronic components

PACKAGE CONTENTS

1x Drowsie - Under Pillow Speaker
1x Charging USB Cable
1x Instruction Manual
1x Warranty
1x Thank You Note



Designed & Made in Australia

© Drowsie™ is a registered trademark of Drowsie Pty Ltd. All rights reserved.



Model: SDDR01 | Grey

For more information, visit www.drowsie.com