



*ionmax*<sup>®</sup>

# SERENE

ULTRASONIC AROMA DIFFUSER

ION138



**USER MANUAL**

## DEAR CUSTOMER

Thank you for purchasing the Ionmax Serene ION138 Ultrasonic Aroma Diffuser. The Ionmax Serene reintroduces moisture into the air to help you maintain a comfortable humidity level in your home. It can help to efficiently relieve respiratory ailments such as colds, flus or hay fever caused by dry air.

Please read this manual carefully to ensure proper usage and save these instructions for future reference.

The package includes:

- ION138 Ultrasonic Serene Aroma Diffuser
- Measuring Cup
- Power Adapter
- User Manual

## CONTENTS

|                          |   |
|--------------------------|---|
| SAFETY INSTRUCTIONS      | 1 |
| PRODUCT DIAGRAM          | 2 |
| SPECIFICATIONS           | 2 |
| FEATURES                 | 3 |
| CONTROL PANEL & SETTINGS | 4 |
| OPERATING INSTRUCTIONS   | 5 |
| CLEANING AND MAINTENANCE | 6 |
| TROUBLESHOOTING GUIDE    | 7 |
| WARRANTY DETAILS         | 8 |
| WARRANTY REGISTRATION    | 9 |

## SAFETY INSTRUCTIONS

When using electrical appliances, basic safety precautions should always be followed to reduce the risk of fire, electric shock and injury to persons, including the following:

1. Check the household voltage to ensure that it matches the unit's rated specification before operating.
2. Children should be supervised to ensure they do not play with the appliance.
3. Do not add water directly to the moisture outlet as this will damage the unit.
4. Do not allow children to play with any product packaging, such as plastic bags.
5. To avoid fire hazard, never put the cord under rugs or near heat registers, radiators, stoves or heaters.
6. Do not place the unit near heat sources such as stoves, radiators and heaters. Do locate your unit on an inside wall near an electrical outlet. The unit should be at least 10cm away from the wall for best results.
7. Do not attempt to refill the unit without first unplugging the unit from its electrical outlet.
8. Do not operate any appliance with a damaged cord or plug, after the appliance malfunctions, or if it has been dropped or damaged in any manner. Return the appliance to the manufacturer for examination, electrical or mechanical adjustment, or repair.
9. Always place the unit on a firm, flat, level surface at least 60cm above the floor and 10cm away from the wall.
10. Do not allow the moisture outlet to directly face the wall.
11. Never tilt, move or attempt to empty the unit while it is operating.
12. Shut off and unplug the unit before removing the tank or moving the unit.
13. Do not attempt to repair or adjust any electrical or mechanical functions on this unit. Doing so will void your warranty. The inside of the unit contains no user serviceable parts. All servicing should be performed by qualified personnel only.
14. Do not plug in the cord with wet hands: this could result in electrical shock.
15. Never use detergents, gasoline, glass cleaner, furniture polish, paint thinner or other household solvents to clean any part of the unit.
16. Do not pour water into any openings other than the water tank.
17. Excessive humidity in a room can cause water condensation on windows and some furniture. If this happens, turn the unit off.
18. Never place the housing under water flow or immerse it in liquid.
19. Do not add more than the recommended amount of essential oil to the unit.

### **CORD AND PLUG INSTALLATION SAFETY INSTRUCTIONS:**

The length of the cord on the unit was selected to reduce the hazards of becoming tangled in, or tripping over a longer cord. If a longer cord is necessary, an approved extension cord may be used. The electrical rating of the extension cord must be equal to or greater than that of the aroma diffuser. Please take extra care to arrange the extension cord so that it will not drape over a countertop or tabletop or where it can be pulled on by children or accidentally tripped over.

## PRODUCT DIAGRAM

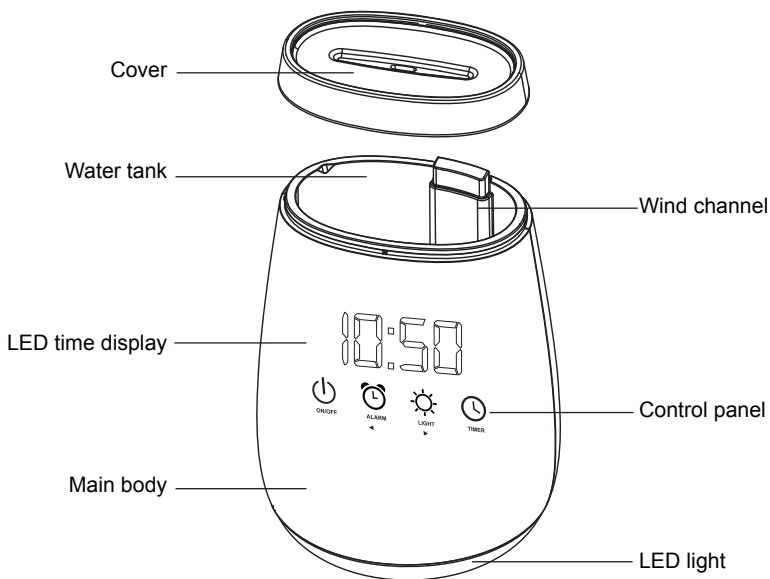

## SPECIFICATIONS

|                          |                                |
|--------------------------|--------------------------------|
| <b>Model</b>             | Ionmax ION138                  |
| <b>Voltage</b>           | AC: 220-240V, 50Hz             |
| <b>Power Rating</b>      | 12W                            |
| <b>Coverage Area</b>     | 15 m <sup>2</sup>              |
| <b>Water Tank Volume</b> | 100 ml                         |
| <b>Weight</b>            | 0.43 kg                        |
| <b>Dimensions</b>        | 116 (L) x 112 (W) x 162 (H) mm |

## FEATURES

This decorative and unique ultrasonic aroma diffuser and humidifier generates a subtle, calming and relaxing scented mist to provide aromatherapy and add moisture to the air.

### 1. **Aromatherapy**

Enjoy the ultimate aromatherapy experience from this little sleek device using your favourite fragrance without any heating elements, making this diffuser safe to use. The advanced ultrasonic technology produces vibrations at high frequency to turn water into mist, creating a soothing and therapeutic atmosphere.

### 2. **Humidifier**

Moisturises and refreshes the quality of air we breathe.

### 3. **Ioniser**

Produces negative ions like those found near beaches and waterfalls, or after a storm.

### 4. **RGB LED Light**

The soft colour-changing LED lighting creates a wonderful tranquil ambience to enjoy.

### 5. **LED Time Display**

Clear LED time display above the touch control panel.

### 6. **Alarm Clock**

This can be used to set when to switch on the unit.

### 7. **Timer**

Set timer to 30, 60, 120 or 180 minutes. The unit will stop automatically when the time runs out.





### “ON / OFF” BUTTON

Touch this button to switch the unit on and off. The aroma diffuser will only function if there is water in the unit. To enable other functions, see below.









### “ALARM” BUTTON

The unit can be set to an alarm. When the alarm goes off, the unit will turn on the aroma diffuser, LED lights in auto colour changing mode, and emit an alarm sound. After 60 seconds, the alarm sound will stop but the unit and the LED lights will remain switched on.

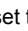
While the alarm is beeping, touch  or  to silence the alarm. Touch  again to switch all functions off.

If no water is in the unit when the alarm is triggered, the unit will enter Standby mode after 60 seconds.

**To set the alarm**, hold  to enter Settings mode. The LED time display will start to flicker. Touch  to set the Minutes and  to set the Hours. Then, press and hold  to confirm and complete the alarm settings.

**To activate or deactivate the alarm**, after an alarm time has been set, touch  to activate the alarm. The  button will light up. Touch  again to deactivate the alarm; the light will turn off.



### “LIGHT” BUTTON

Touch this button to turn the light mode on or off. Continue touching to select the desired light mode between auto changing, red, green, blue and off.





### “TIMER” BUTTON

The unit can be timed to operate for intervals of 30 minutes, 60 minutes, 120 minutes and 180 minutes, stopping automatically when the selected operating time has elapsed. For continuous operation, touch  repeatedly until the LED time display screen shows “0000”.

## LED TIME DISPLAY

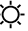
Press and hold  to enter Settings mode. The LED time display will start to flicker.

Touch  to set the Minutes and touch  to set the Hours. After you have set the desired time, press and hold  to confirm and complete the time settings.

## OPERATING INSTRUCTIONS

### FOR FIRST TIME USE

Please remove the battery film from the back of the unit before use.

1. Remove the cover.



2. Use the measuring cup to add water to the water tank. Do not fill beyond the MAX level mark of the unit. The aroma diffuser will not work if filled beyond the the MAX level mark.

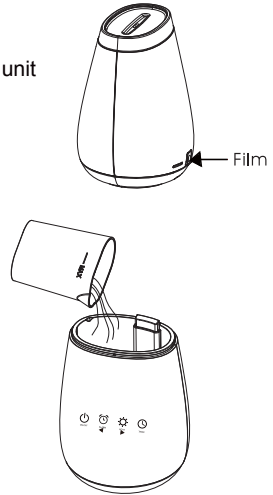

Do not attempt to pour water into the aroma diffuser with the cover in place.

3. Add 3-5 drops of essential oil to the water.

Do not exceed the suggested amount and always follow the essential oil manufacturer's instructions for safe use.



4. Replace the cover.

5. Connect the aroma diffuser to a power outlet using the included power cable, and switch on the unit.

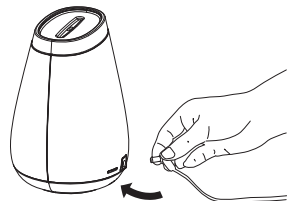

## CLEANING AND MAINTENANCE

Please follow all maintenance instructions carefully. These steps are essential to prevent microorganisms growing in the water within the aroma diffuser.

### A) After each use

1. Turn the unit off and unplug the unit from the electrical outlet. Then lift off the top cover.
2. Drain and rinse the water tank thoroughly after each use to remove any sediment and dirt. Wipe clean and dry with a clean soft cloth or paper towel.

### B) Daily maintenance

1. Before cleaning, turn the power off and unplug the unit from its electrical outlet.
2. Remove the water tank from the base of the unit.
3. Carry the water tank to a sink, then drain and rinse the water tank thoroughly to remove any sediment or dirt. Wipe clean and dry it with a clean soft cloth or paper towel.
4. Refill the water with cool tap water as instructed in the Operating Instructions.

### C) Weekly maintenance

1. Repeat steps 1-3 above.
2. Pour one cup of white vinegar (about 50 -100ml) into the base in the main body and leave for about 15 minutes. Then, wipe off the scale (especially in the transducer) with a soft brush or cotton swab.
3. Wipe off the scale and white vinegar solution using a clean soft cloth.

### D) Maintenance caution

1. Never submerge the main body in water.
2. Do not use any solvents or aggressive cleaning agents to clean the unit.
3. Clean the internal parts with a soft cloth.
4. Use only a soft brush, cloth or cotton swab to clean the transducer. This should be done once a week.
5. Change the water in the water tank at least once a week to ensure that water is not left standing for more than one week.

### E) Storing the aroma diffuser

1. Clean the unit as described above and dry thoroughly.
2. Preferably, store the unit in its original box.
3. Avoid exposing the unit to high temperatures.



## TROUBLESHOOTING GUIDE

If your aroma diffuser is not working correctly, please check the following causes:

| Problem  | Possible Cause  | Solution   |
|--|---|--|
| Unit not operating                                     | Power cable not plugged in  | Plug in power cable                                    |
| The power light is on, but the humidifier doesn't work | Too much water in the tank  | Pour away some water from the tank                     |
|  | No water in water tank  | Fill tank with water                                   |
| Water mist produces an unpleasant smell.               | Previous aroma not completely cleaned or removed                      | Clean the water tank thoroughly                        |
|  | Dirty water or the water has been left in the water tank for too long | Clean the water tank and refill with fresh, cool water |
| Mist output volume is low                              | The transducer is dirty   | Clean transducer using vinegar and a soft brush        |
|  | Dirty water or the water has been left in the water tank for too long | Clean the water tank and refill with fresh, cool water |
| Abnormal noise   | Unit is on an unstable or uneven surface                              | Move the unit to a stable, flat surface                |
| Water is leaking from the unit                         | Unit faulty   | Contact customer support                               |
| Button unresponsive                                    | Function not available in current mode                                | See Operating Instructions                             |
|  |   | Contact customer support                               |
| Clock resets when power goes out                       | Battery film not removed  | Remove battery film (see page 5)                       |
|  | Battery is dead   | Contact customer support                               |



## WARRANTY DETAILS

**Congratulations on your purchase!** It is our aim to provide you with quality products that you can trust. Our products come with guarantees that cannot be excluded under the Australian Consumer Law. You are entitled to a replacement or a refund for a major failure and for compensation for any other reasonably foreseeable loss or damage.

You are also entitled to have the goods repaired or replaced if the goods fail to be of acceptable quality and the failure does not amount to a major failure.

### The Guarantee

The product is guaranteed to be free from defects in workmanship and parts for a period of 12 months from date of purchase. Defects that occur within this warranty period, under normal use and care, will be repaired, replaced or refunded at our discretion, solely at our option with no charge for parts and labour. The benefits conferred by this warranty are in addition to all rights and remedies in respect of the product that the consumer has under the Trade Practices Act and similar state laws.

### Proof of Purchase

This warranty is valid for the original purchase and is not transferable. Please keep your purchase docket or receipt as proof of purchase and as proof of date on which the purchase was made. The purchase docket (or a copy) or receipt must be presented with the warranty when making a claim under this warranty.

### Service during the Warranty Period

To claim for warranty, contact us on 1300 800 200 or [support@andatech.com.au](mailto:support@andatech.com.au) to get an RA# (Return Authorisation Number) or submit a support ticket on [my.andatech.com.au](http://my.andatech.com.au). Ensure that the RA# is clearly stated on the outside of the packaging and that the product is properly packaged so that no damage occurs to the product during transit. Shipping of the product back to us for warranty will be at your cost. A product return without the RA# or proof of purchase will not be accepted.

### Extent of Warranty

This warranty is limited to defects in workmanship or parts. All defective products or parts will be repaired or replaced. This warranty does not cover manuals and packaging.

### Normal Wear and Tear

This warranty does not cover normal wear and tear to the product or parts.

### Exclusions

This warranty does not cover:

- Any defect caused by an accident, misuse, abuse, improper operation, lack of reasonable care, unauthorised modification, loss of parts, tampering or attempted repair by a person not authorised by the distributor.
- Any product that has been damaged by a lightning strike either directly or indirectly or a main power surge or liquid ingress.
- The product if it is located outside of Australia.
- Any damage caused by improper power input or improper cable connection.

---

**Andatech Corporation Pty. Ltd.**

PO Box 3038, Nunawading VIC 3131, Australia.

Phone: 1300 800 200 Fax: 1300 883 802 Email: [support@andatech.com.au](mailto:support@andatech.com.au)

A circular badge with a thick border containing the text "1 YEAR WARRANTY" in a bold, sans-serif font.

**1 YEAR  
WARRANTY**

# WARRANTY REGISTRATION

Register your Ionmax Serene ION138 online at [my.andatech.com.au](http://my.andatech.com.au) or fill out this form and forward to the address below with a copy of your proof of purchase. Contact us on 1300 800 200 or visit [www.andatech.com.au](http://www.andatech.com.au) for options to extend your warranty.

**Andatech Corporation Pty Ltd**  
**PO Box 3038, Nunawading VIC 3131, Australia.**

|                   |   |                             |
|-------------------|---|-----------------------------|
| Product           | : | <b>Ionmax Serene ION138</b> |
| Date of Purchase  | : | _____                       |
| Place of Purchase | : | _____                       |
| Serial No.        | : | _____                       |
| Surname           | : | _____                       |
| Given Name        | : | _____                       |
| Address           | : | _____                       |
| Suburb            | : | _____                       |
| Postcode          | : | _____                       |
| State             | : | _____                       |
| Contact No.       | : | _____                       |
| Email             | : | _____                       |





ionmax.com.au  
1300 800 200

Version 1. Updated 11.06.2015.